

STACKING INSTRUCTIONS

Tumble Action Washer/Dryer

⚠ WARNING To reduce the risk of electrical shock, disconnect this appliance from the power supply before attempting any user maintenance. Turning the controls to the OFF position does not disconnect this appliance from the power supply.

⚠ WARNING Refer to the washer and dryer installation instructions packed with each appliance prior to stacking appliances. Reading all of the information contained in these instructions will simplify the installation and ensure a correct and safe operation. A fire hazard and/or personal injury could result from improper installation.

KIT # 6 530393 7141

TOOL & EQUIPMENT REQUIREMENTS:

1. Phillips screwdriver.
2. Channel-lock pliers.

Mounting the Dryer to the Washer:

1. Remove the washer top panel by first removing the four (4) screws in the two (2) brackets located on the top rear of the washer.

Slide the top forward, lift the front of the top up, and remove the top panel.

Remove the two (2) brackets from the rear of the top panel.

2. Using the four (4) screws that were removed in step 1, install the brackets in the rear support as shown.
3. Remove the four (4) screws and the two (2) long front brackets located on the top front of the washer.
4. Install the two (2) new front mounting brackets, provided in the kit, with the four (4) screws that were removed in step 3. Note that the tab of the front mounting bracket is facing forward as shown in the illustration.

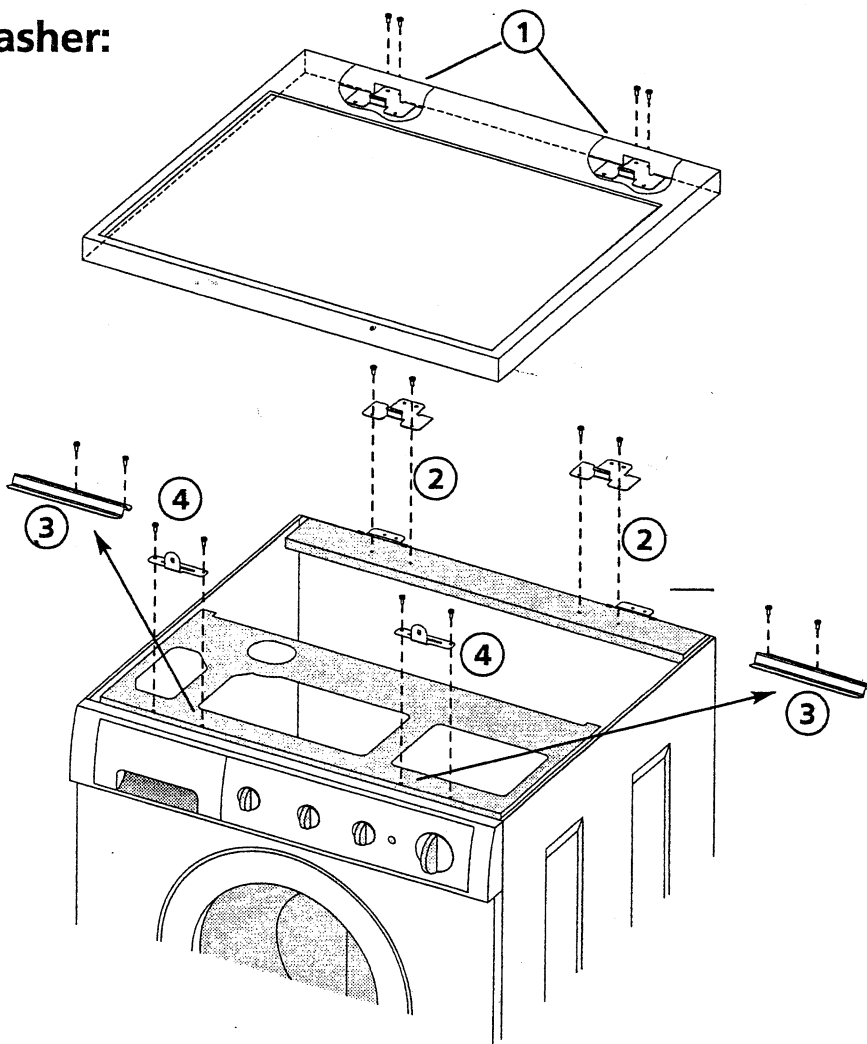

(continued, reverse side)

Numbers correspond to steps.

Mounting the Dryer to the Washer

(continued)

5. Carefully remove the hole plugs located in the bottom of the dryer front panel.
6. Remove the four (4) legs from the dryer base.
7. Place the dryer on top of the washer. Slide back into the rear brackets (7A) then drop the front down behind the front brackets (7B).
8. Insert the two (2) long screws, provided in the kit, through the holes in the dryer front panel and install into the front mounting brackets.
9. Install the hole plugs removed in step 5.
10. Refer to the washer and dryer installation instructions for proper installation and function.
11. Save the top panel and brackets in the case of future side by side use.

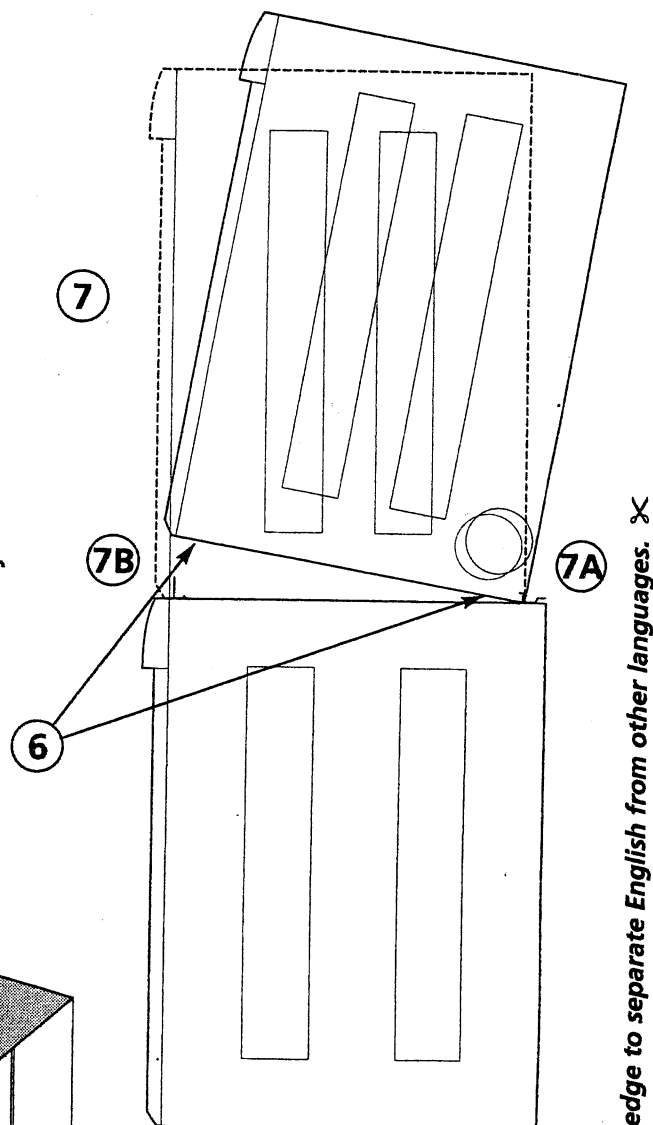

✂ Cut along this edge to separate English from other languages. ✂

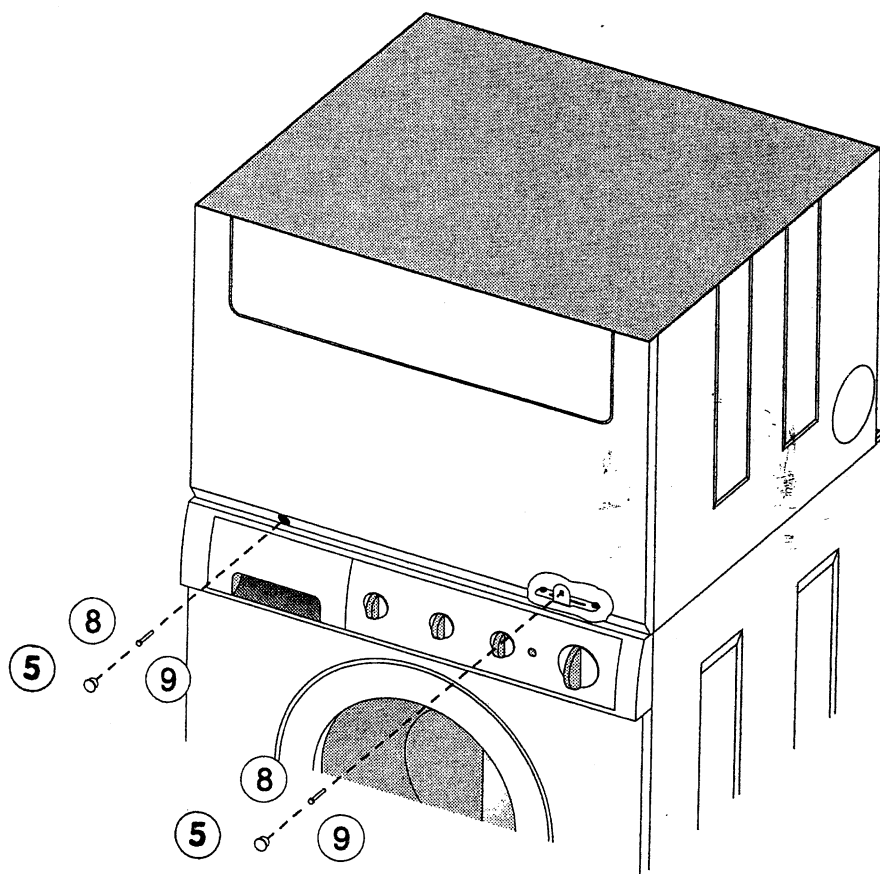

Numbers correspond to steps.

Stacking Two Dryers

Two stack dryers can be mounted on top of one another. The best way to do it is:

1. Order two (2) rear mounting two brackets - P/N 5303281173.
2. Remove the leveling legs of number one dryer.
3. Remove the top panel of the number two dryer.
4. Remove the front panel of number one dryer.
5. Stack number one dryer on top of number two dryer.
6. Using one of the rear mounting brackets as a template, mark the holes in the rear bracket.
7. Drill four 1/8" holes and attach the brackets with #8 or #10 screws.
8. Remove the stacking kit from one of the dryers.
9. Tilt number one dryer back and brace up 12 inches.
10. Using one of the brackets as a template, mark four holes in the front bracket.
11. Drill four 1/8" holes and attach the brackets with #8 or #10 screws.
12. Lower number one dryer and install the long mounting screws from the kit.
13. Install the front panel on number one dryer.